

## DATA SHEET

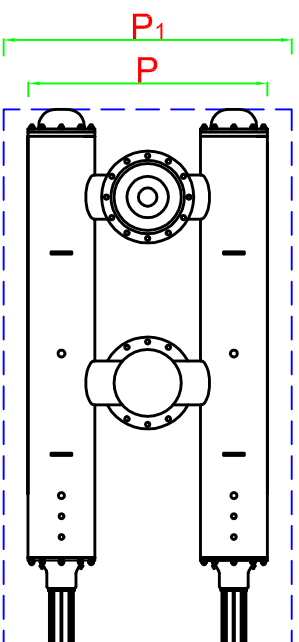
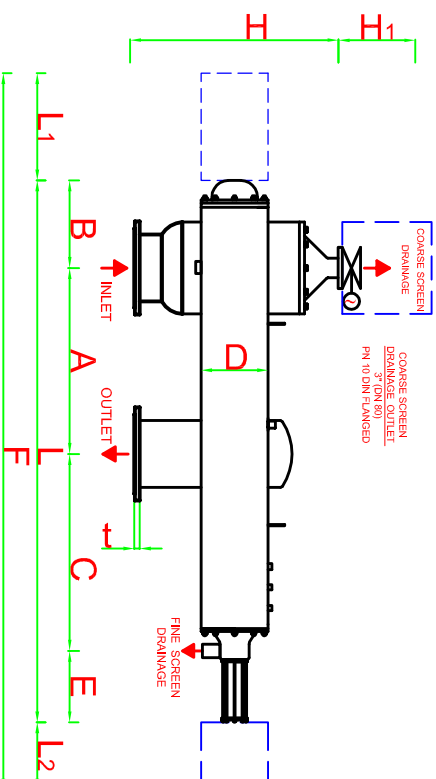
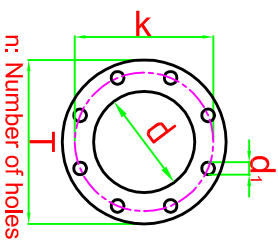

For high pressure, high temperature and different materials, custom made filters can be produced.

Body Material:	AISI 304L (316L optional)
Screen Material:	AISI 316L
Max. Operating Pressure:	10 bar
Min. Inlet Pressure Required During Back-Flush:	2 bar
Max. Operating Temperature:	60 °C
Headloss at Max. Flow Rate:	0.2 bar
Approximate Back-Flush Time:	40-60 sec.
Approximate Back-Flush Water Consumption:	300-400 lt/back-flush
Coarse Screen Back-Flush Outlet:	Automatic valve
Fine Screen Control System:	Electric
Coarse Screen Control System:	Electric

FILTER MODEL	INLET/OUTLET		FLANGE SIZES ND 10 - DIN 2576						A min.	L	L1	L2	F	B	C	E	D	H	H1	P	P1	WEIGHT(kg)		MAX. FLOW RATE m³/h	FILTRATION AREA cm²	
	inch	DN	d	T	k	d1	n	t														FULL	EMPTY		1. STAGE	2. STAGE
KTW 210608	8	200	219.1	340	295	22	8	24	900	2385	1700	500	4585	260	885	340	10"	680	865	1175	1975	700	270	350	3800	14400

All dimensions are in millimeters.

Aniel-Fitemox reserves the rights to modify any of the technical information in this document without prior notification. All the rights for this drawing are belonging to ANIEL TREATMENT SYSTEM CONS.INDRCOM.CO.INCIt can not be copied or given to the persons without permission.